

AULA AU3.L2.1500.XY

**Type:** wall lamp

**Lampshade:** acrylic glass

**Light body:** painted steel plate RAL 9016 (.41), RAL 7012 (.47), RAL Argento dorato (.70), RAL Copper (.72), RAL Bronze (.73), RAL Brass (.74)

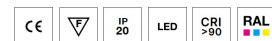
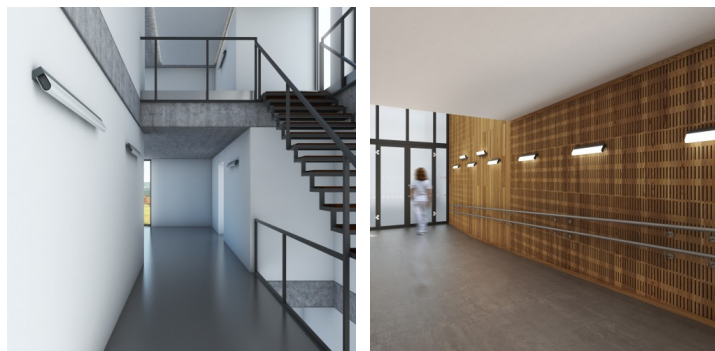
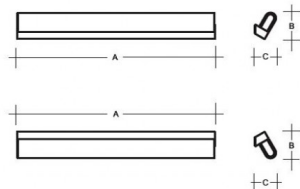

W	K	Module luminous flux lm	Luminaire luminous flux lm	A	B	C	DALI 2	Motion sensor	Emergency module	Bluetooth	Track system	Weight
51	4000	7015	6591	1500	120	95	M	-	-	Q*	-	4000

Lucis AU3.L2.1500.X AULA LED / LDC (Polar)

**Voltage:** 230V

**IK code:** IK06

**Ballast:** Driver

**CRI:** >90

**LED life:** L80/F10 50000 hours

**Watt:** 51 W

**Color temperature:** 4000 K

**Module luminous flux:** 7015 lm

**Luminaire luminous flux:** 6591 lm

**A:** 1500 mm

**B:** 120 mm

**C:** 95 mm

**Dali 2:** Available

**Motion sensor:** Not available

**Emergency module:** Not available

**Bluetooth control:** Available on inquiry

**Track system:** Not available

**Sádrokarton:** Not available

**Weight:** 4000 g

Luminaire: Lucis AU3.L2.1500.X AULA LED  
Lamps: 1 x LED G6

