

AULA AU3.L4.1200.XY

Type: wall lamp

Lampshade: acrylic glass

Light body: painted steel plate RAL 9016 (.41), RAL 7012 (.47), RAL Argento dorato (.70), RAL Copper (.72), RAL Bronze (.73), RAL Brass (.74)

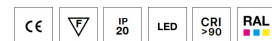
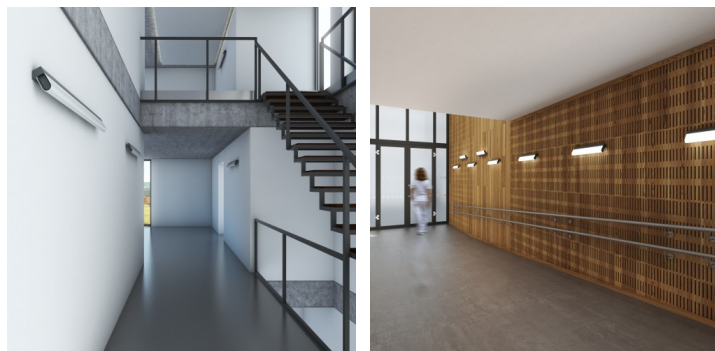
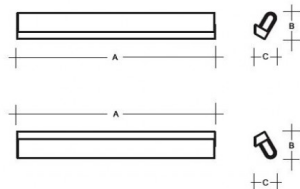

W	K	Module luminous flux lm	Luminaire luminous flux lm	A	B	C	DALI 2	Motion sensor	Emergency module	Bluetooth	Track system	Weight
20,2	4000	2912	2736	1200	120	95	M	-	-	Q*	-	3300

Lucis AU3.L4.1200.X AULA LED / LDC (Polar)

Voltage: 230V

IK code: IK06

Ballast: Driver

CRI: >90

LED life: L80/F10 50000 hours

Watt: 20,2 W

Color temperature: 4000 K

Module luminous flux: 2912 lm

Luminaire luminous flux: 2736 lm

A: 1200 mm

B: 120 mm

C: 95 mm

Dali 2: Available

Motion sensor: Not available

Emergency module: Not available

Bluetooth control: Available on inquiry

Track system: Not available

Sádrokarton: Not available

Weight: 3300 g

Luminaire: Lucis AU3.L4.1200.X AULA LED
Lamps: 1 x LED G6

