

AULA AU3.L1.350.X

Type: wall lamp

Lampshade: acrylic glass

Light body: painted steel plate RAL 9016 (.41), RAL 7012 (.47), RAL Argento dorato (.70), RAL Copper (.72), RAL Bronze (.73), RAL Brass (.74)

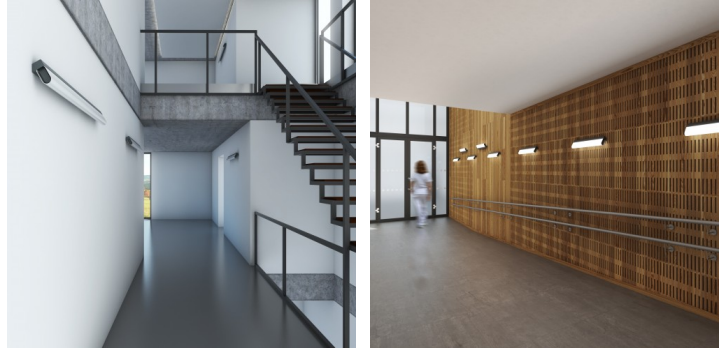
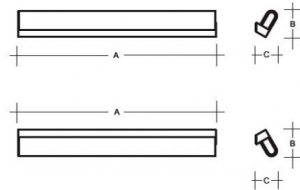

| W | K | Module luminous flux lm | Luminaire luminous flux lm | A | B | C | DALI 2 | Motion sensor | Emergency module | Bluetooth | Track system | Weight |
|-----|------|-------------------------|----------------------------|-----|-----|----|--------|---------------|------------------|-----------|--------------|--------|
| 9,1 | 3000 | 1230 | 1156 | 350 | 120 | 95 | M | - | - | - | - | 1000 |

Lucis AU3.L1.350.X AULA LED / LDC (Polar)

Voltage: 230V

IK code: IK06

Ballast: Driver

CRI: >90

LED life: L80/F10 50000 hours

Watt: 9,1 W

Color temperature: 3000 K

Module luminous flux: 1230 lm

Luminaire luminous flux: 1156 lm

A: 350 mm

B: 120 mm

C: 95 mm

Dali 2: Available

Motion sensor: Not available

Emergency module: Not available

Bluetooth control: Not available

Track system: Not available

Sádrokarton: Not available

Weight: 1000 g

Luminaire: Lucis AU3.L1.350.X AULA LED
Lamps: 1 x LED G6

