

RETRO ZT ZT.11.R19.XY





Typ: Pendelleuchte

Lampenschirm: weißes, mundgeblasenes, dreischichtiges Opalglass seidenmatt

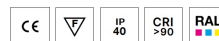
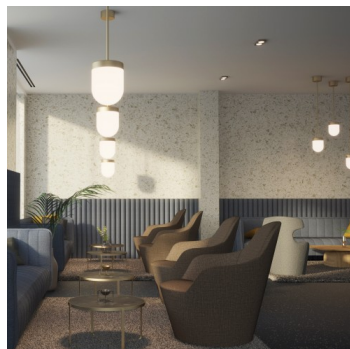
Metallteile: lackiertes Stahlblech RAL 9016 (.41), RAL 9005 (.45), RAL Kupfer (.72), RAL Bronze (.73), RAL Messing (.74) oder RAL Chrom (.77)

Federung: Stahlrohr



|  |  | A | B | C |  |  |  |
|---|---|-----|-----|------|---|---|---|
| E27 | 1x100W(max 13W LED) | 190 | 250 | 1000 | - | R* | 3000 |

Spannung: 230V

Fassung: E27

Leuchtmittel: 1x100W(max 13W LED)

A: 190 mm

B: 250 mm

C: 1000 mm

Bewegungsmelder: Nicht Verfügbar

Track-System: Verfügbar auf Anfrage

Gewicht: 3000 g

Lucis ZT.11.R19.X RETRO / LDC (Polar)

Luminaire: Lucis ZT.11.R19.X RETRO
Lamps: 1 x Osram CL 100W

