

RETRO ZT ZT.11.R19.XY





Type: luminaire suspendu

Abat-jour: verre blanc, soufflé de manière artisanale, à trois couches, satin opale mat

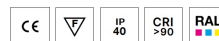
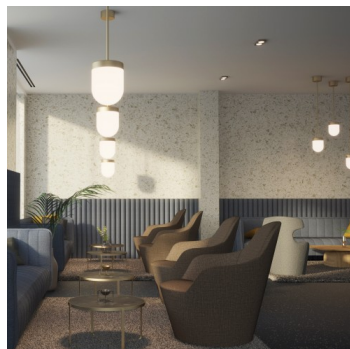
Les pièces métalliques: acier laqué RAL 9016 (.41), RAL 9005 (.45), RAL Cuivre (.72), RAL Bronze (.73), RAL Laiton (.74) ou RAL Chrom (.77)

Suspension: tube



		A	B	C			
E27	1x100W(max 13W LED)	190	250	1000	-	R*	3000

Tension: 230V

Douille: E27

Lampe: 1x100W(max 13W LED)

A: 190 mm

B: 250 mm

C: 1000 mm

Capteur de mouvement: Non disponible

Track system: Disponible sur demande

Poids: 3000 g

Lucis ZT.11.R19.X RETRO / LDC (Polar)

Luminaire: Lucis ZT.11.R19.X RETRO
Lamps: 1 x Osram CL 100W

