

TENDO PMMA S26.K2.TEZ2.Y

Type: ceiling and wall lamp

Lampshade: acrylic glass PMMA

Light body: white painted steel plate

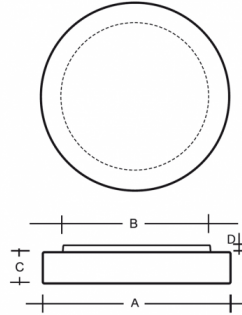

W	K	Module luminous flux lm	Luminaire luminous flux lm	A	B	C	D	DALI 2	IK10	IK11	Bluetooth	Emergency	Weight
18,1	4000	2491	1790	300	260	70	20	M	-	-	Q*	-	1200

Voltage: 230V

Ballast: Driver

IK code: IK10

CRI: >90

LED life: L80/F10 50000 hours

Watt: 18,1 W

Color temperature: 4000 K

Module luminous flux: 2491 lm

Luminaire luminous flux: 1790 lm

A: 300 mm

B: 260 mm

C: 70 mm

D: 20 mm

Dali 2: Available

Motion sensor: Not available

Emergency module: Not available

Bluetooth control: Available on inquiry

Track system: Not available

Sádrokarton: Not available

Weight: 1200 g

Lucis S26.K2.TEZ2 TENDO LED / LDC (Polar)

Luminaire: Lucis S26.K2.TEZ2 TENDO LED
Lamps: 1 x LED G5

