

TENDO PMMA S33.K4.TEZ3.Y

**Type:** ceiling and wall lamp

**Lampshade:** acrylic glass PMMA

**Light body:** white painted steel plate

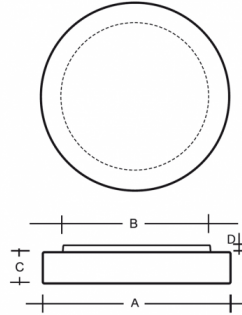

W	K	Module luminous flux lm	Luminaire luminous flux lm	A	B	C	D	DALI 2	Motion sensor	P*	Q*	IP	LED	CRI	TW	Weight
23,3	4000	3197	2397	370	330	70	20	M	O*	P*	Q*	-	-	>90	TW	1900

**Voltage:** 230V

**Ballast:** Driver

**IK code:** IK10

**CRI:** >90

**LED life:** L80/F10 50000 hours

**Watt:** 23,3 W

**Color temperature:** 4000 K

**Module luminous flux:** 3197 lm

**Luminaire luminous flux:** 2397 lm

**A:** 370 mm

**B:** 330 mm

**C:** 70 mm

**D:** 20 mm

**Dali 2:** Available

**Motion sensor:** Available on inquiry

**Emergency module:** Available on inquiry

**Bluetooth control:** Available on inquiry

**Track system:** Not available

**Sádrokarton:** Not available

**Weight:** 1900 g

Lucis S33.K4.TEZ3 TENDO LED / LDC (Polar)

Luminaire: Lucis S33.K4.TEZ3 TENDO LED  
Lamps: 1 x LED G5

