

TENDO PMMA S44.K1.TEZ4.Y

Type: ceiling and wall lamp

Lampshade: acrylic glass PMMA

Light body: white painted steel plate

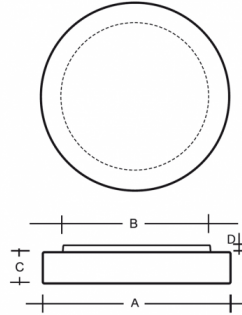

W	K	Module luminous flux lm	Luminaire luminous flux lm	A	B	C	D	DALI 2	Motion sensor	Emergency module	Bluetooth	Track system	Weight
44,5	3000	5810	4295	460	440	80	20	M	O*	P*	Q*	-	2600

Voltage: 230V

Ballast: Driver

IK code: IK10

CRI: >90

LED life: L80/F10 50000 hours

Watt: 44,5 W

Color temperature: 3000 K

Module luminous flux: 5810 lm

Luminaire luminous flux: 4295 lm

A: 460 mm

B: 440 mm

C: 80 mm

D: 20 mm

Dali 2: Available

Motion sensor: Available on inquiry

Emergency module: Available on inquiry

Bluetooth control: Available on inquiry

Track system: Not available

Sádrokarton: Not available

Weight: 2600 g

Lucis S44.K1.TEZ4 TENDO LED / LDC (Polar)

Luminaire: Lucis S44.K1.TEZ4 TENDO LED
Lamps: 1 x LED G5

