

BOWL S0.K2.B45.Y

**Type:** ceiling and wall lamp

**Lampshade:** white, hand-blown, three-layered glass, satin opal matt

**Light body:** white painted steel plate

The first glass ceiling and wall luminaire, triplex opal matt, with an invisible fixture in the shade of the luminaire allowing clean and direct compositions of opal glass with different types of materials.

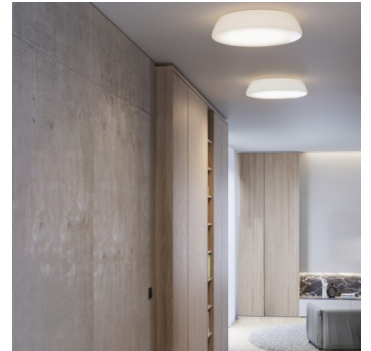
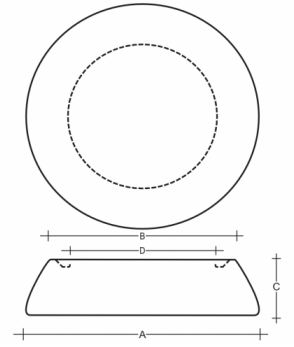
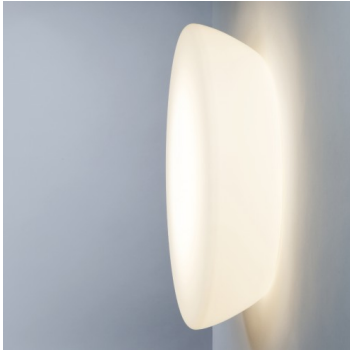

W	K	Module luminous flux lm	Luminaire luminous flux lm	A	B	C	D	DALI 2	IP 40	LED	CRI >90	TW	Person icon	
15,5	4000	2506	1898	450	350	110	285	M	-	-	Q*	-	-	4900

**Voltage:** 230V

**IK code:** IK01

**Ballast:** Driver

**CRI:** >90

**LED life:** L80F10>72000 hodin

**Watt:** 15,5 W

**Color temperature:** 4000 K

**Module luminous flux:** 2506 lm

**Luminaire luminous flux:** 1898 lm

**A:** 450 mm

**B:** 350 mm

**C:** 110 mm

**D:** 285 mm

**Dali 2:** Available

**Motion sensor:** Not available

**Bluetooth control:** Available on inquiry

**Track system:** Not available

**Sádrokarton:** Not available

**Weight:** 4900 g

Project 1



**Lucis S0.K2.B45 BOWL LED / LDC (Polar)**

Luminaire: Lucis S0.K2.B45 BOWL LED  
Lamps: 1 x LED G6

