

ZERO S43.K1.Z500.Y

**Type:** ceiling and wall lamp

**Lampshade:** white, hand-blown, three-layered glass, satin opal matt

**Light body:** white painted steel plate

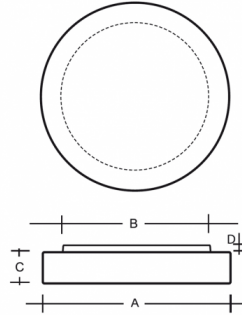

W	K	Module luminous flux lm	Luminaire luminous flux lm	A	B	C	D	DALI 2	Motion sensor	Emergency module	Bluetooth	Track system	Weight
44,5	3000	5810	4533	500	430	90	20	M	O*	P*	Q*	-	4500

**Voltage:** 230V

**IK code:** IK01

**Ballast:** Driver

**CRI:** >90

**LED life:** L80/F10 50000 hours

**Watt:** 44,5 W

**Color temperature:** 3000 K

**Module luminous flux:** 5810 lm

**Luminaire luminous flux:** 4533 lm

**A:** 500 mm

**B:** 430 mm

**C:** 90 mm

**D:** 20 mm

**Dali 2:** Available

**Motion sensor:** Available on inquiry

**Emergency module:** Available on inquiry

**Bluetooth control:** Available on inquiry

**Track system:** Not available

**Sádrokarton:** Not available

**Weight:** 4500 g

Luminaire: Lucis S43.K1.Z500 ZERO LED / LDC (Polar)

Luminaire: Lucis S43.K1.Z500 ZERO LED  
Lamps: 1 x LED G5

