

CHARON IP44 PS29.12.T135.Y





Type: luminaire de plafond et mural

Abat-jour: verre blanc, soufflé de manière artisanale, à trois couches, satin opale mat

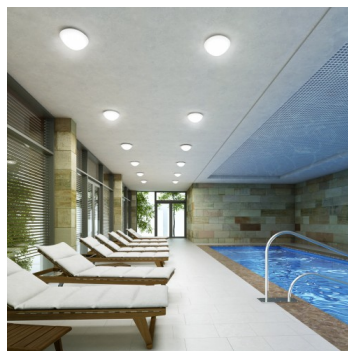
Luminaire: tôle en acier peint en blanc

Could be combined with metal ring in white, chrome, brass or stainless steel.



		A	B	C			
E27	2x75W(max 11W LED)	360	290	130	0*	-	2900

Tension: 230V

IK code: IK01

Douille: E27

Lampe: 2x75W(max 11W LED)

A: 360 mm

B: 290 mm

C: 130 mm

Capteur de mouvement: Disponible sur demande

Track system: Non disponible

Poids: 2900 g

Lucis PS29.112.T135 CHARON / LDC (Polar)

Luminaire: Lucis PS29.112.T135 CHARON
Lamps: 2 x Osram CL 75W

